

MAX 50 le + MICROFORST rc

le = linear extension
rc = radio controlled

Remote controlled carrier with forestry mulcher

The **MAX 50 le** is a radio-controlled mulcher that is built to last. With 49 HP, the vehicle offers maximum reliability thanks to the industrial 3-cylinder turbo diesel engine T4F/STAGE V from Perkins. Its optimally positioned low center of gravity due to the extendable track width handles steep slopes providing complete safety for the operator. The track width can be extended up to 181 cm [71"] and can thus manage slopes up to 55° of incline. The generous hydraulic power promises the necessary torque to master even the most difficult situations.

MAX 50 le Tracked tool carrier

- > Lifting linkage with assisted floating **FLOAT**
- > Chassis with roll-bar
- > Internal components protected by steel hoods
- > Underbody protections protects the motor and hydraulics
- > Hydraulic adjustment of the vehicle width 500 mm (2x250 mm) [20 inch = 2x10 inch]
- > Active **AUTO TRACK TENSION** system
- > Stability and traction due to superior track profile with high ground contact and LGP undercarriage **HIGH GRIP**
- > Automatic reversible fan
- > Remote control with display (Vital machine diagnostics and incline display) 2.4 Ghz - 160 m range
- > 3 Cylinder T4F/STAGE V Perkins engine 1660 cc
- > 2 auxiliary double acting hydraulic functions
- > Closed circuit triple piston pump with variable displacement, plus additional gear pump
- > Optional forestry rear protection with winch

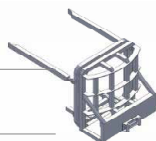

MICROFORST rc 125 Forestry mulcher

- > Mulches wood up to 15 cm [6"] Ø
- > Chassis made of wear-resistant steel AR400
- > Belt transmission
- > 30 cc PISTON MOTOR with flushing valve
- > Hydraulically operated hood
- > Guard frame
- > Reinforced support skids, adjustable in height
- > Helical rotor with fixed hammers of choice MINI DUO CARBIDE inserts hammers or MINI BLADE with CUT CONTROL gauge



www.youtube.com/seppimulcher

Specifications	MAX 50 le	MICROFORST rc
Rotor working width	-	125 cm [49"]
Overall width	131-181 cm [52-71"]	144 cm [57"]
Depth	215 cm [85"]	86 cm [34"]
Height	119 cm [47"]	76 cm [30"]
Weight	1.400 kg [3.090 lb]	330 kg [730 lb]
Fixed hammers	-	27

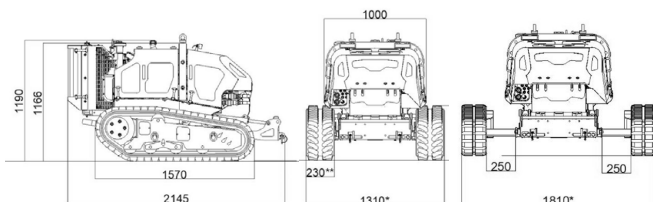

Power & high-performance hydraulic drive

MAX 50 le		DIESEL FUEL TANK	HYDRAULIC FLUID TANK	MULCHER HYDRAULICS		TRACKS HYDRAULICS		SECONDARY HYDRAULICS	
HP [kW]	l/min [gpm]	l [gallon]	l [gallon]	bar [psi]	l/min [gpm]	bar [psi]	l/min [gpm]	bar [psi]	l/min [gpm]
49 [36]	15 [4]	29 [7.5]	50 [13]	320 [4,640]	80 [21]	320 [4,640]	104 [27]	200 [2,900]	15 [4]

EXTENDABLE UNDERCARRIAGE for extending the width of the individual tracks. Powerful when climbing and crossing extreme slopes. With the enlarged undercarriage, the mulcher works more efficiently and precisely on extreme and uneven grades.



A special feature is the radio control, which is equipped with a graphic display that monitors all functions and interference. The frequency range is 2.4 GHz and covers distances up to 160 m.

Hydraulic system with self-tensioning tracks



FLOAT
Lifting linkage with assisted floating

Rollbar

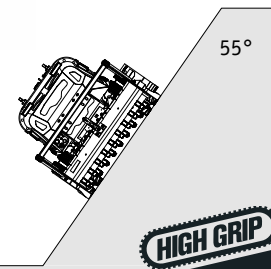
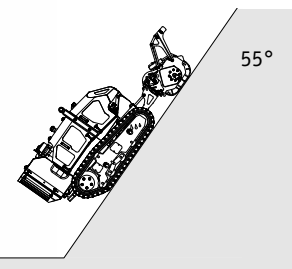

Stability and grip of the vehicle on difficult terrain up to 55° slopes, under optimal conditions

CARBIDE



Standard rotor: MINI DUO hammer
2 tungsten carbide tips provide high performance and long lifetime
> Efficient on big wood and stumps

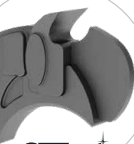

CUT CONTROL

Optional rotor: CUT CONTROL system
The sharpenable blade of the MINI BLADE tool with the specially developed gauge reduces the depth of cut
> Fast cut and fine mulch on wood and standing trees