

XAN

Sweeper collects cut wood and brings it in front of the mulcher

The **XAN sweeper** is available

- for the front attachment to a tractor
- for fixed attachment to a mulcher
- with quick coupling 2-FAST for connection to a mulcher
- with quick coupling 2-FAST for connection to the carrier PORT-X

With the XAN sweeper you may collect leaves and prunings from row sides and bring them into an ideal position for mulching: in front of the mower or in front of the tractor.

Features	XAN
Working speed	1-5 km/h
Attachment	Tractor*(XAN front), mulcher or PORT-X
Connection	Mulcher or PORT-X: quick coupling Tractor (XAN front): plate
Flow rate	30-40 l/min [8-10 gpm]
Hoses	120 cm [47 inch]
Anti shock device	Touch spring
Rotor	Supporting turning disc
Tools	3 rubber vanes

* Controls: 1-2 additional double-acting control units

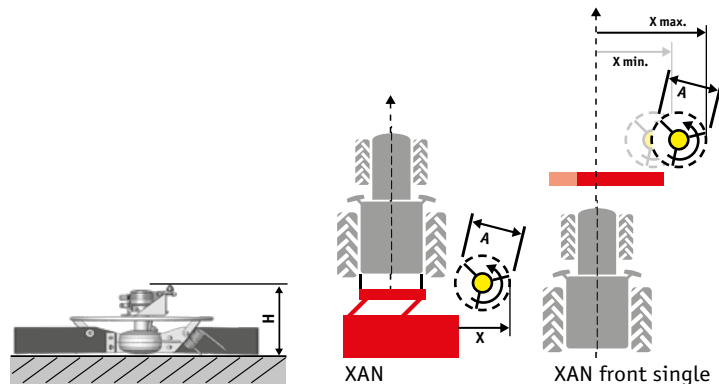

working width A: cm ["]	XAN	XAN front single	height H: cm ["]	weight* kg [lb]
	distance from border of mulcher X: cm ["]	distance from middle of tractor X min-max: cm ["]		
115 [45]	100 [39]	150-187 [59-74]	35 [14]	54 [119]

* The weight of the machine is approximate and may vary.



Anti-shock device



Rubber vanes with reinforced steel spring

Front attachment on the tractor without front linkage

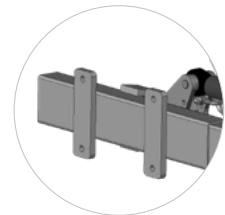

Folds for transport:
XAN: manual
XAN front single & double: hydr.

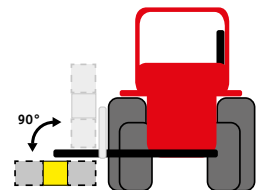

Season	- autumn - winter
Ideal Situation	- from ca. 2 cm [0.8"] diameter - leaves and prunings - dry soil - slight slope up to ca. 10°
Advantages	- prevents decomposition - gathers side lying prunings - takes the habitat of the pest - no damage on the trunks